

# spaTouch™ 2 & 3

## Installation Guide



- spaTouch™ 3
- spaTouch™ 3+

- spaTouch™ 2
- spaTouch™ 2C



VISIT US ONLINE  
[www.BalboaWaterGroup.com](http://www.BalboaWaterGroup.com)

# TOPSIDE PANEL INSTALLATION

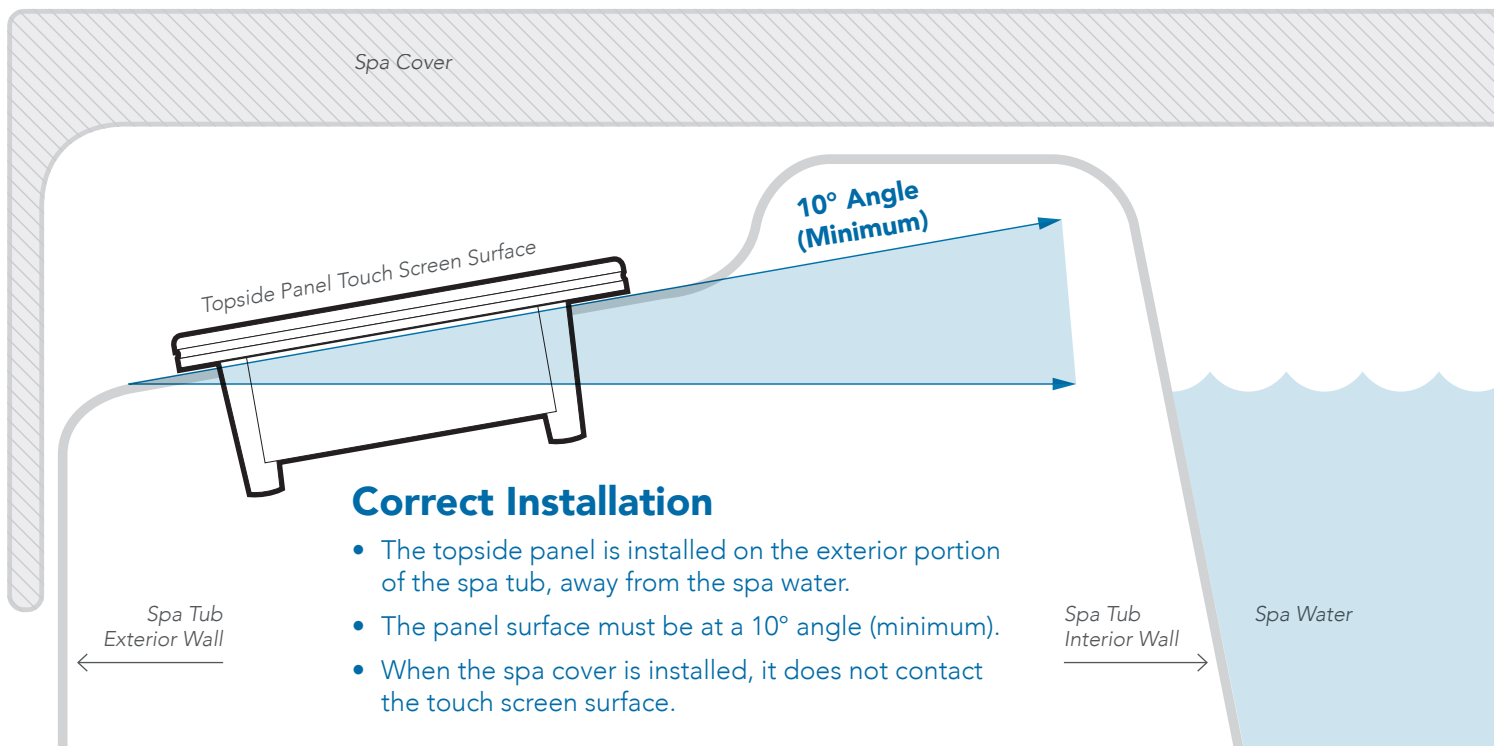

## Correct Installation

- The topside panel is installed on the exterior portion of the spa tub, away from the spa water.
- The panel surface must be at a 10° angle (minimum).
- When the spa cover is installed, it does not contact the touch screen surface.

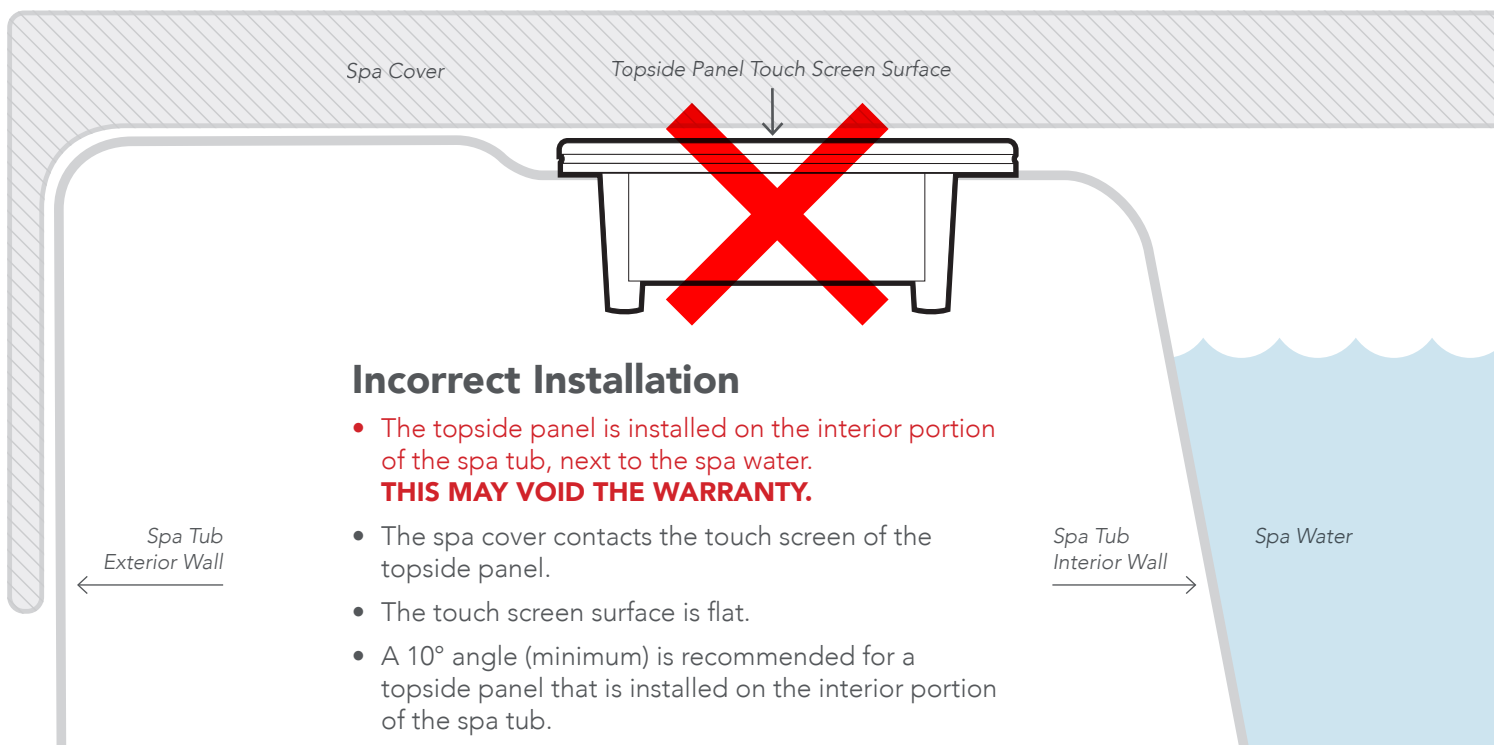

## Incorrect Installation

- The topside panel is installed on the interior portion of the spa tub, next to the spa water.  
**THIS MAY VOID THE WARRANTY.**
- The spa cover contacts the touch screen of the topside panel.
- The touch screen surface is flat.
- A 10° angle (minimum) is recommended for a topside panel that is installed on the interior portion of the spa tub.



## spaTouch™ 2 & 3

 Email

---

[info@balboawater.com](mailto:info@balboawater.com)

 Phone

---

P : + 714.384.0384  
Customer Service is available:

M - TH 7:30AM to 7:00PM  
F - 7:30AM to 5:00PM PT

 Corporate Office

---

Balboa Water Group  
3030 Airway Avenue  
Costa Mesa, CA 92626



### **MEXICO OPERATIONS**

Balboa Water Group  
Aguila Azteca 6011  
Baja Maq. El Aquila  
Mexico 22221

### **EUROPEAN OPERATIONS**

Balboa Water Group  
Hydroair International  
ApS Roustvej 50 DK-6800  
Varde